



Technical Data Sheet

Revision: March 15, 2025
Supersedes: New
Ref. #: Tool/Article

Cartridge Opener & Smoothing Tool

DESCRIPTION

GE Cartridge Opener & Smoothing Tool is a 2-in-1 tough plastic tool that makes it easier to create a professional looking sealant bead. The cartridge opener side opens all cartridges and squeeze tubes without risk. The smoothing side allows for a perfect finish on seals.

Available as:

Item #	Package	Color
3023644	Carded tool	Black

FEATURES & BENEFITS

- Easy to use
- Achieve a professional finished look with smoothing side
- Cutter for all plastic cartridges and squeeze tubes

RECOMMENDED FOR

Use with acrylic, latex, silicone, polyurethane, solvent, and hybrid polymer sealants

INSTRUCTIONS FOR USE

1. If removing old silicone sealant first, use the GE Sealant Remover Tool. Once removed, clean the area thoroughly with isopropyl alcohol/rubbing alcohol.
2. Cut the cartridge nozzle or squeeze tube to the desired size using the integrated cutter, following the direction of the arrow (Figure 1).
3. Apply a continuous bead of sealant evenly to the surface.
4. Moisten the smoothing end of the tool with water and smooth the new bead with the hollow side of the spoon, pulling it to collect the excess sealant (Figure 2).
5. Clean the Cartridge Opener & Smoothing Tool immediately after use with a damp cloth.

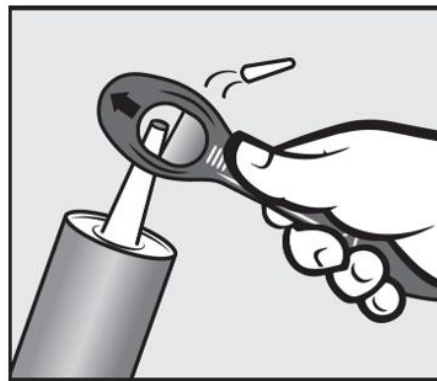

Figure 1

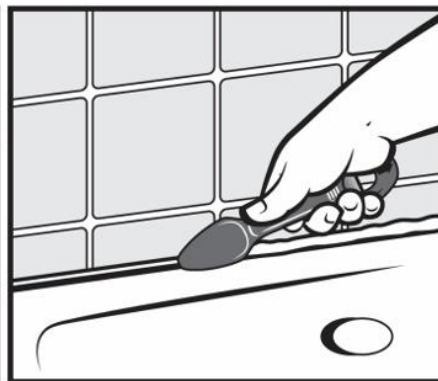

Figure 2



Technical Data Sheet

Revision: March 15, 2025
Supersedes: New
Ref. #: Tool/Article

LABEL PRECAUTIONS

CAUTION! Sharp points and edges. **KEEP OUT OF REACH OF CHILDREN**

DISCLAIMER

The information and recommendations contained herein are based on our research and are believed to be accurate, but no warranty, express or implied, is made or should be inferred. Henkel recommends purchasers/users should test the products to determine acceptable quality and suitability for the intended use. All adhesive/sealant applications should be tested under simulated or actual end use conditions to ensure the adhesive/sealant meets or exceeds all required project specifications. Since assembly conditions may be critical to adhesive/sealant performance, it is also recommended that testing be performed on specimens assembled under simulated or actual production conditions. Nothing contained herein shall be construed to imply the nonexistence of any relevant patents or to constitute a permission, inducement, or recommendation to practice any invention covered by any patent, without authority from the owner of the patent.

LIMITED WARRANTY

This product is warranted by Henkel Corporation to be free from defects in materials when used as directed. Henkel's sole obligation shall be, at its option, to replace or refund the purchase price of product proven to be defective. Henkel makes no other warranty – express or implied – including warranties of MERCHANTABILITY and FITNESS FOR A PARTICULAR PURPOSE and will not be liable for consequential or incidental damages. This Limited Warranty gives you specific legal rights, which vary from state to state. For warranty assistance, contact Henkel at 1-877-607-7407 M-F 9:00 am to 4:00 pm ET.

GE is a registered trademark of General Electric Company and is used under trademark license by Henkel.

For Technical Assistance call : 1-877-607-7407 – Mon - Fri 9:00a – 4:00p ET
www.gesealants.com



Founded in 1876, Henkel is a global leader in the consumer and industrial businesses. Henkel operates worldwide with leading brands and technologies in three business areas: Laundry & Home Care, Beauty Care and Adhesive Technologies.

Henkel Corporation - Professional & Consumer Adhesives Headquarters - Rocky Hill, CT 06067
www.henkelna.com